

8S-151, 16S-1621 TD/1921 TD/2221 TD/ 2321 TD/2331 TD, 16S-1821 TO/2221 TO/2521 TO/2721 TO/2731 TO, 16S-151/181/221.10, 10 Bolts. / Pistón Lateral / Side Piston , 2 Salidas Independientes / 2 Independent Outputs

## Posterior Neumático Rear Pneumatic

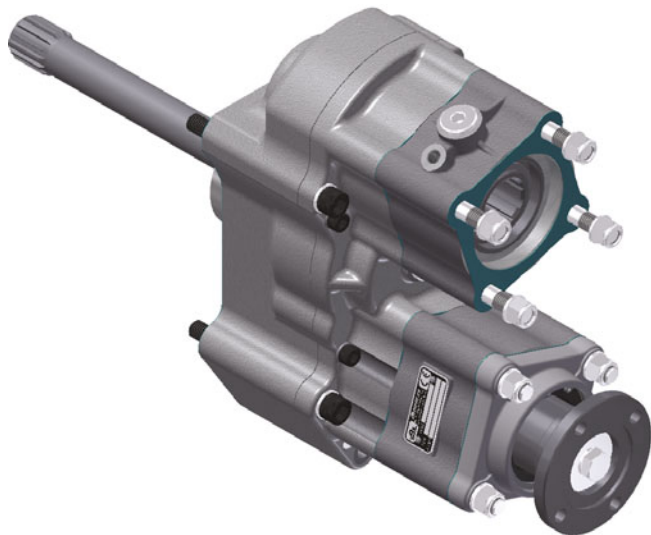

## Descripción Description

Toma de fuerza doble salida independiente de 3 piñones en toma constante, (1:1,60). Accionamiento neumático, montaje sobre el registro frontal de la caja de cambios. Indicadores de funcionamiento opcionales.

Twin output PTO for Pump and independent, (1:1,60) constant mesh. Pneumatic shifting, mounting rear 9 bolts-window of the Gearbox. Optional: Passing contact switches.

### Datos Principales (Ambas salidas) Main Data (Both Outputs)

Par nominal Torque (Nm)	500	
Potencia (Cv) a 1000 r.p.m. Power (HP) 1000 r.p.m	70 C.V // 53 Kw	
Sentido de giro Sense of rotation	Bomba Pump	Derecho Clockwise
	Plato Flange	Izquierdo Anti-Clock
Relación motor - Toma de Fuerza Engine to PTO ratio	ANEXO ATTACHMENT	

### Datos Generales General Data

Peso Weight (Kg)	15
Lado de montaje Mounting side	Posterior Rear
Par máx. continuo en ambas salidas conjuntas Max. Continuous Torque for both outputs	600 Nm

### Códigos y Combinaciones Part Numbers and Combinations

Tipos de salidas Output types	Salida superior Upper Output	Plato Flange	Plato Flange	Bomba Pump	Bomba Pump
	Salida inferior Bottom Output	Plato Flange	Bomba Pump	Plato Flange	Bomba Pump
Accionamiento neumático Pneumatic shifting	1028352	1028351	1028350	1028353	

8S-151, 16S-1621 TD/1921 TD/2221 TD/ 2321 TD/2331 TD, 16S-1821 TO/2221 TO/2521 TO/2721 TO/2731 TO, 16S-151/181/221.10 - 10 Bolts. / Pistón Lateral / Side Piston - 2 Salidas Independientes / 2 Independent Outputs

## Posterior Neumático Rear Pneumatic

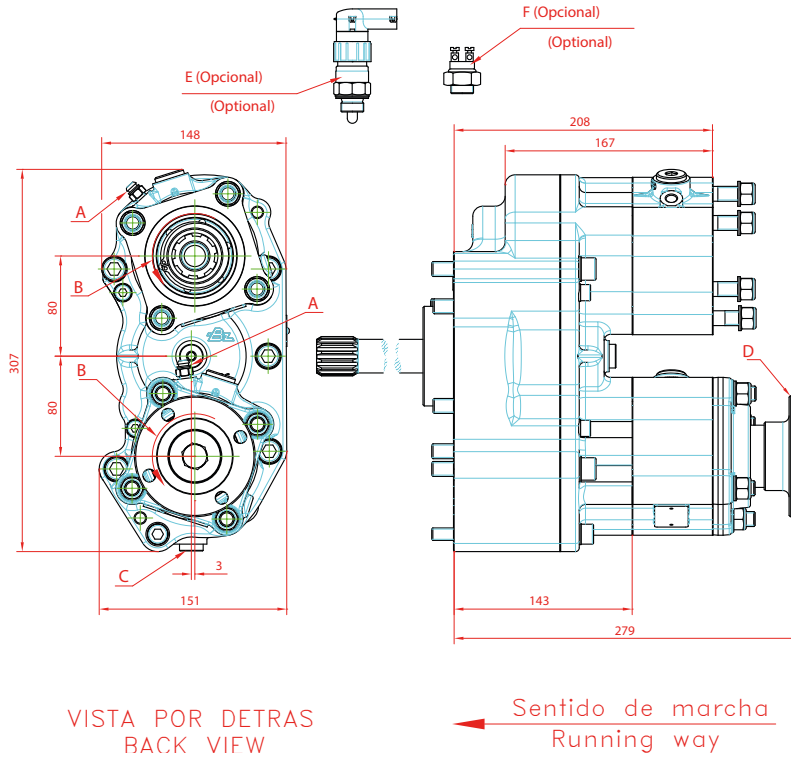

### Notas Notes

A	Tomas de aire, rosca 1/8" GAS.	A	Air connection, thread BSP 1/8"
B	Sentidos de giro	B	Senses of rotation
C	Tapón de drenaje del aceite	C	Oil drain plug
D	Brida de transmisión	D	Flange drive
E	Interruptores de contacto (9024999)	E	Passing contact switches. P/N 9024999
F	Interruptor neumático (100070018)	F	Pressure switch P/N (100070018)

## Tipos de Salida Output Types

### Adaptador Plato / Flange Adapter

FLANGE TYPE	Part Number	
SAE:	1100	7015504
	1300	
	1400	7015604
DIN:	90	7015804
	100	7015704

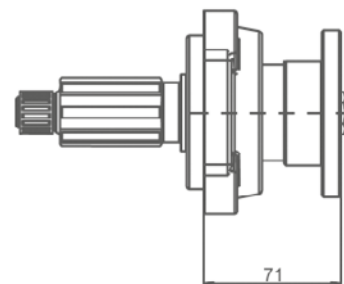
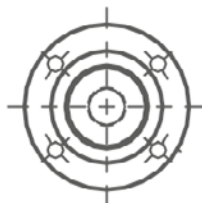

8S-151, 16S-1621 TD/1921 TD/2221 TD/ 2321 TD/2331 TD, 16S-1821 TO/2221 TO/2521 TO/2721 TO/2731 TO,  
16S-151/181/221.10 - 10 Bolts. / Pistón Lateral / Side Piston - 2 Salidas Independientes / 2 Independent Outputs

## Posterior Neumático Rear Pneumatic

## Anexo Attachment

CAJA GEARBOX		RELACIÓN RATIO	
8S	151/13.79		1:1,490
	1620 TD/13.80-1.0		1:1,474
	1820 TO/11.54-0.84		1:1,766
	220 TO/11.54-0.84		1:1,766
12S	2100 TD	15.57-1.0	Normal Normal 1:1,312
	2300 TD		Larga High 1:1,668
	2800 TD		
16S	151/13.85-0.84		Normal Normal 1:1,247 Larga High 1:1,490
	1820 TO/13.80-0.84		Normal Normal 1:1,474 Larga High 1:1,766
	2220 TO/13.80-0.84		Normal Normal 1:1,474 Larga High 1:1,766
	2520 TO/13.80-0.84		Normal Normal 1:1,474 Larga High 1:1,766
	2720 TO/13.80-0.84		Normal Normal 1:1,474 Larga High 1:1,766
	2730 TO/13.80-0.84		Normal Normal 1:1,474 Larga High 1:1,766
	1620 TD/16.41-1.0		Normal Normal 1:1,247 Larga High 1:1,474
	1920 TD/16.41-1.0		Normal Normal 1:1,247 Larga High 1:1,474
	2220 TD/16.41-1.0		Normal Normal 1:1,247 Larga High 1:1,474
	2320 TD/16.41-1.0		Normal Normal 1:1,247 Larga High 1:1,474
	2330 TD/16.41-1.0		Normal Normal 1:1,247 Larga High 1:1,474
	151/13.80IT		Larga High 1:1,490 Normal Normal 1:1,247
	151/13.85IT		Larga High 1:1,490 Normal Normal 1:1,247
	151/16.41IT		Larga High 1:1,490 Normal Normal 1:1,247
	151/16.47IT		Larga High 1:1,490 Normal Normal 1:1,247
	151/16.53IT		Larga High 1:1,490 Normal Normal 1:1,247
	181/13.80IT		Larga High 1:1,490 Normal Normal 1:1,247
	181/13.85IT		Larga High 1:1,490 Normal Normal 1:1,247

CAJA GEARBOX		RELACIÓN RATIO	
16S	181/16.41IT	Larga High	1:1,490
		Normal Normal	1:1,247
	181/16.47IT	Larga High	1:1,490
		Normal Normal	1:1,247
	181/16.53IT	Larga High	1:1,490
		Normal Normal	1:1,247
	221/13.80IT	Larga High	1:1,490
		Normal Normal	1:1,247
	221/13.85IT	Larga High	1:1,490
		Normal Normal	1:1,247
	221/16.41IT	Larga High	1:1,490
		Normal Normal	1:1,247
	221/16.47IT	Larga High	1:1,490
		Normal Normal	1:1,247
	221/16.53IT	Larga High	1:1,490
		Normal Normal	1:1,247
	1621 TD/16.41-1.0 IT	Larga High	1:1,474
		Normal Normal	1:1,247
	1921 TD/16.41-1.0 IT	Larga High	1:1,474
		Normal Normal	1:1,247
	2221 TD/16.41-1.0 IT	Larga High	1:1,474
		Normal Normal	1:1,247
	2321 TD/16.41-1.0 IT	Larga High	1:1,474
		Normal Normal	1:1,247
	2331 TD/16.41-1.0 IT	Larga High	1:1,474
		Normal Normal	1:1,247
	1821 TO/13.80-0.84 IT	Larga High	1:1,766
		Normal Normal	1:1,474
	2221 TO/13.80-0.84 IT	Larga High	1:1,766
		Normal Normal	1:1,474
	2521 TO/13.80-0.84 IT	Larga High	1:1,766
		Normal Normal	1:1,474
2721 TO/13.80-0.84 IT	Larga High	1:1,766	
	Normal Normal	1:1,474	
2731 TO/13.80-0.84 IT	Larga High	1:1,766	
	Normal Normal	1:1,474	