

G210, G221, G230, G231, G240, G241, G260, G280, G281, G330

2 Salidas Independientes - Casquillo cierre bomba  
2 Independent Outputs - Closed pump cover

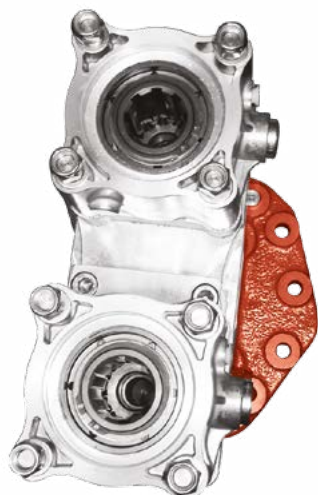

## Descripción Description

Toma de fuerza doble salida 3 piñones + brida (sin eje), relación en salida superior 1:1,30. Relación en salida inferior 1:1,72. Montaje en el registro posterior de 8 taladros de la caja de cambios. Accionamiento neumático. Indicador de funcionamiento opcional.

Power Take-off twin output 3 gears + flange kit (without shaft), ratio (top output) 1:1,30. Ratio (bottom output) 1:1,72. Mounting on rear 8 bolts-window of the Gearbox. Pneumatic shifting. Optional: Passing contact switch.

### Datos Generales General Data

Peso Weight (Kg)	15
Lado de montaje Mounting side	Posterior Rear
Par máx. continuo en ambas salidas conjuntas Max. Continuous Torque for both outputs	490 Nm. No sobrepasar este par cuando trabajen ambas salidas Don't exceed this torque with both output running.

### Datos Principales Main Data

		Salida Superior Upper Output	Salida Inferior Bottom Output
Par nominal Torque (Nm)	Continuo Continuous	350	300
	Intermitente Intermittent	490	420
Potencia (1000 r.p.m.) - Power (1000 r.p.m.)		52 C.V // 39 kW	42 C.V // 32 kW
Sentido de giro Sense rotation	Bomba Pump	Derecho ClockWise	
	Plato Pump	Izquierdo Anti ClockWise	
Relación motor - Toma de Fuerza Engine to PTO ratio		Anexo 1 Attachment 1	Anexo 2 Attachment 2

### Códigos y Combinaciones Part Numbers and Combinations

Kit toma de fuerza Base con brida Base PTO kit with flange					+	Kit de eje adaptador Adapter shaft kit	
Tipos de salidas Output types	Plato/Plato Plate/Plate	Plato/Bomba Plate/Pump	Bomba/Bomba Pump/Pump	Bomba/Plato Pump/Plate		G330, Z=16. L=252mm	700904
						G330 Retarder. Z= 16. L=277mm	703704
Codigo Part Number	07224K52	07224K51	07224K53	07224K50		G281 Powershift 3, Z=16. L=293mm (Aquatarder)	7018104

G210, G221, G230, G231, G240, G241, G260, G280, G281, G330

2 Salidas Independientes - Casquillo cierre bomba  
 2 Independent Outputs - Closed pump cover

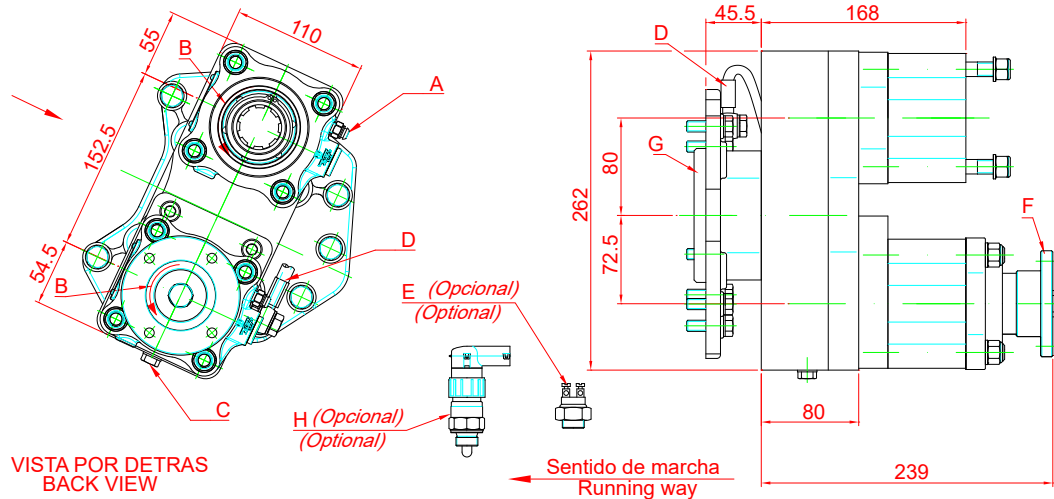

Notas		Notes	
A	Tomas de aire, rosca 1/8" GAS.	A	Air connection, thread BSP 1/8 BSP"
B	Sentidos de giro	B	Senses of rotation
C	Tapón de drenaje del aceite	C	Oil drain plug
D	Kit de lubricación (9013899)	D	Lubrication Kit (9013899)
E	Interruptor neumático (100070018)	E	Pressure switch. P/N 100070018
F	Brida de transmisión	F	Flange drive
G	Casquillo cierre bomba engrase	G	Closed lubrication pump cover
H	Interruptor de contacto (9024999)	H	Passing contact switch. P/N 9024999

## Tipos de Salida Output Types

### Adaptador Plato / Flange Adapter

SAE:	1100	7015504
	1300	
	1400	7015604
DIN:	90	7015804
	100	7015704

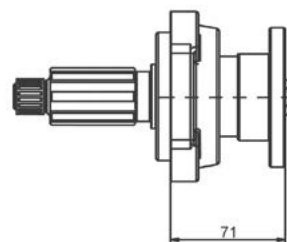
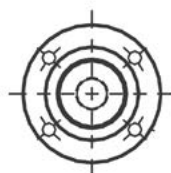

G210, G221, G230, G231, G240, G241, G260, G280, G281, G330

2 Salidas Independientes - Casquillo cierre bomba  
 2 Independent Outputs - Closed pump cover

	Anexo I	Attachment I	
G210-16/14.2-0.83	Normal	Normal	1:1,105
	Larga	High	1:1,339
G211-16/17.0, G231-16/17.0, G241-16K/17.0-1.0	Normal	Normal	1:0,923
	Larga	High	1:1,105
G221-9/16.15-1.0			1:0,962
G240-16/11.7, G280-16K/11.72-0.69, G280-16/11.72-0.69 NewAMT	Normal	Normal	1:1,339
	Larga	High	1:1,612
G260-16/9.75-0.57	Normal	Normal	1:1,612
	Larga	High	1:1,95
G281-12K/14.93-1.0, G281-12K/14.93-1.0, G281-12/14.93-1.0 NewAMT	Normal	Normal	1:1,053
	Larga	High	1:1,339
G230-12K/11.67-0.78, G230-12/11.67-0.78 NewAMT, G230-16S/14.2-0.83, G330-12K/11.64-0.78, G330-12/11.64-0.78 NewAMT	Normal	Normal	1:1,339
	Larga	High	1:1,716

	Anexo II	Attachment II	
G210-16/14.2-0.83	Normal	Normal	1:1,462
	Larga	High	1:1,772
G211-16/17.0, G231-16/17.0, G241-16K/17.0-1.0	Normal	Normal	1:1,221
	Larga	High	1:1,462
G221-9/16.15-1.0			1:1,273
G240-16/11.7, G280-16K/11.72-0.69, G280-16/11.72-0.69 NewAMT	Normal	Normal	1:1,772
	Larga	High	1:2,133
G260-16/9.75-0.57	Normal	Normal	1:2,133
	Larga	High	1:2,58
G281-12K/14.93-1.0, G281-12K/14.93-1.0, G281-12/14.93-1.0 NewAMT	Normal	Normal	1:1,393
	Larga	High	1:1,772
G230-12K/11.67-0.78, G230-12/11.67-0.78 NewAMT, G230-16S/14.2-0.83, G330-12K/11.64-0.78, G330-12/11.64-0.78 NewAMT	Normal	Normal	1:1,772
	Larga	High	1:2,270