

DT6E OPERATING CHARACTERISTICS

	FLOW							SPEED (rpm)		PRESSURE (bar)		WEIGHT (Kgs.)
	Lts/min.at 1000 rpm	132	142	156	197	213	227	270	Min.	Máx.	Intermit.	
Gal/min.at 1200 rpm	42	45	50	62	66	72	85	500	2200*	240	210	44

* See page 41 for further information about speed & pressure.

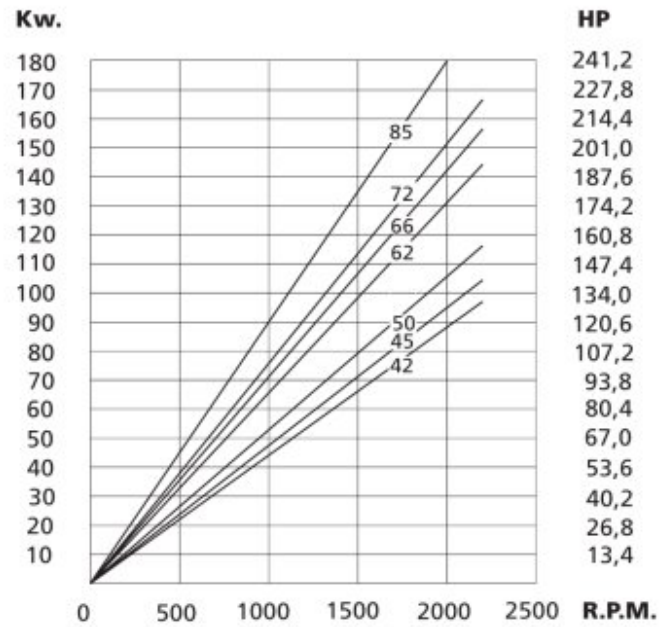
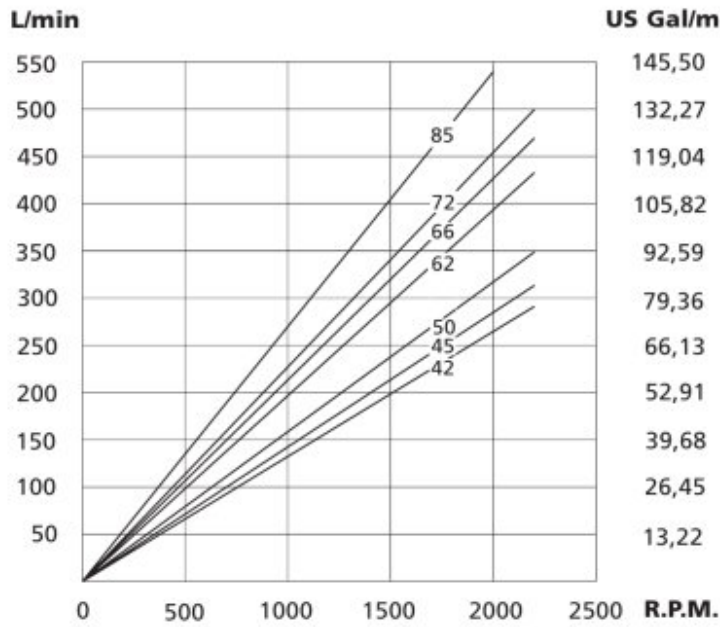

Theoretical Flow (0 Bar)

To calculate the real flow at a given operating pressure, subtract the internal leakage value for this pressure (see diagram below) from the theoretical flow. (See diagram above).

Theoretical Input Power at 200 Bar

To calculate the theoretical input power at other pressures and speeds, use the formula:

$$P(Kw) = \frac{Q(L/min.) \times P(Bar)}{600}$$

Where Q is the theoretical flow (upper left diagram) and P the operating pressure.

To calculate the real input power, add to the theoretical power the hydromechanical power losses (see diagram below).

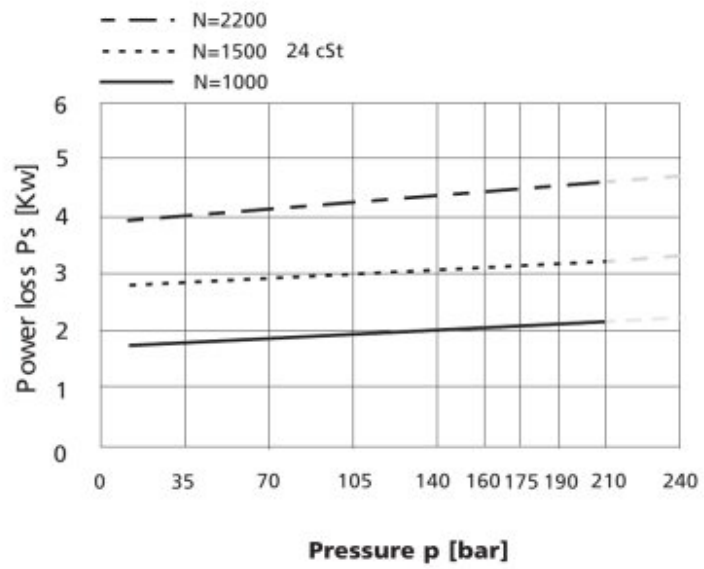
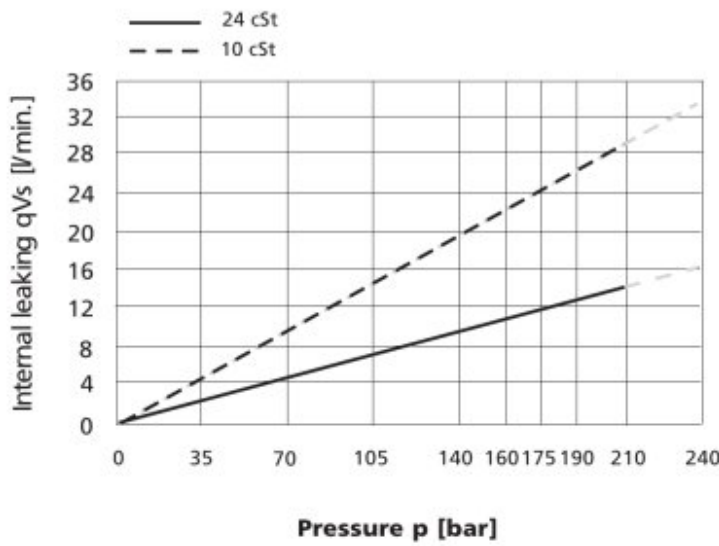

DIMENSIONS - SINGLE VANE PUMPS DT6E

DIMENSIONS IN MILLIMETERS. 1" = 25,4 mm

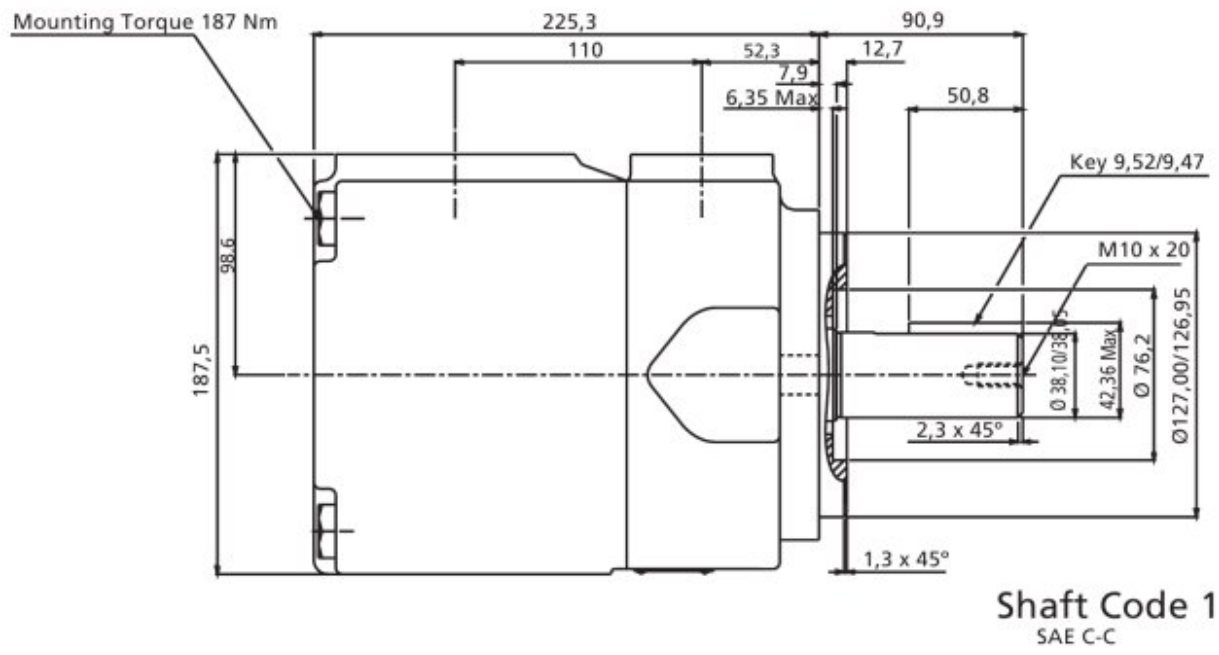
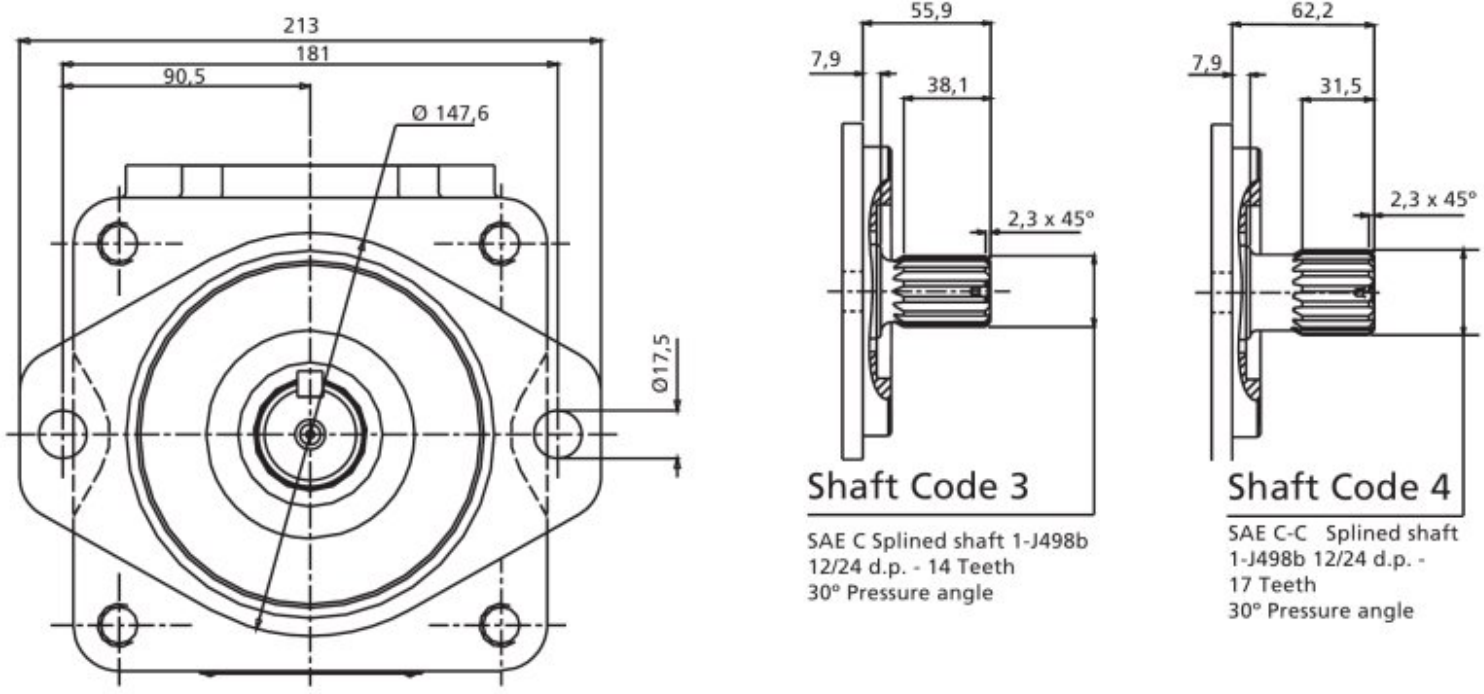

Shaft Code 1
SAE C-C

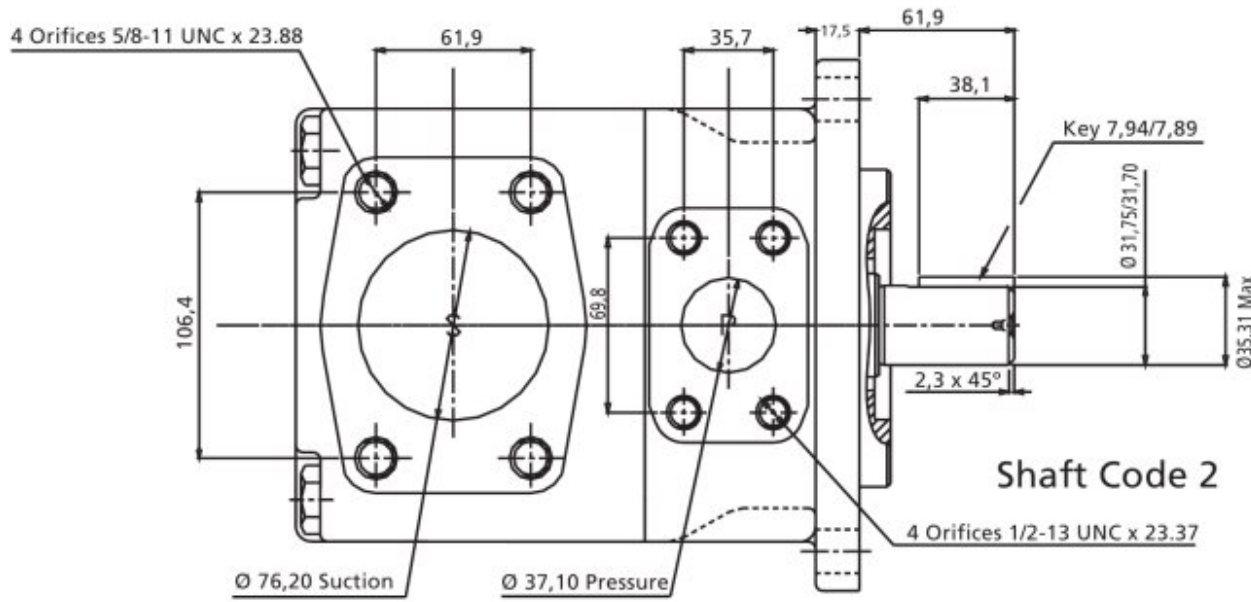

Shaft Code 2