

# Bomba Hidráulica Hydraulic Pump

código code

VARIOS

# BZ 61/71/81/101



## Descripción Description

Bomba de pistones en línea con sentido de giro reversible.

Axial piston pump with reversible sense of rotation.

## Datos Principales Main Data

| Tipo de Bomba<br>Pump Type                                     |           | BZ 61          | BZ 71          | BZ 81          | BZ 101         |
|--|-----------|----------------|----------------|----------------|----------------|
| Codigo<br>Code   |           | <b>5033706</b> | <b>5033806</b> | <b>5033606</b> | <b>5033906</b> |
| Presión de trabajo<br>Operating pressure (kg/cm <sup>2</sup> ) | Máx       | 350            | 350            | 350            | 310            |
|  | Máx. Cont | 300            | 300            | 300            | 280            |
| Velocidad de trabajo<br>Operating Speed (r.p.m)                | Máx       | 1700           | 1650           | 1600           | 1500           |
|  | Máx. Cont | 1500           | 1450           | 1400           | 1300           |
| Desplazamiento<br>Displacement (cm <sup>3</sup> /rev)          |           | 60             | 70             | 80             | 100            |
| Peso<br>Weight (Kg)  |           | 15.9           | 15.7           | 16             | 16.2           |

|   |   |   |  |
|---|---|---|--|
| Dirección de Rotación Sense of Rotation |   | Reversible<br>Bi-directional            |  |
| Presión de Entrada Input Pressure       | Recomendado<br>Recommended  | 7 ÷ 3 bar (abs)                         |  |
| Temperaturas Temperatures               |   | Desde -25°C a +80°C From -25°C to +80°C |  |
| Aceite recomendado Oil Recommended      | La especificación para el aceite debe estar conforme con la norma DIN 51524 / 51525 (tipo HLP).<br>The specification of the fluid must conform to DIN 51524 / 51525 (type HLP). |   |  |
| Viscosidad Viscosity                    | Recomendado<br>Recommended  | De 12 ÷ 100 mm <sup>2</sup> /s (cST)    |  |
|   | Permitido<br>Allowed  | Max. 750 mm <sup>2</sup> /s (cST)       |  |

# Bomba Hidráulica Hydraulic Pump

código code

**VARIOS**

# BZ 61/71/81/101

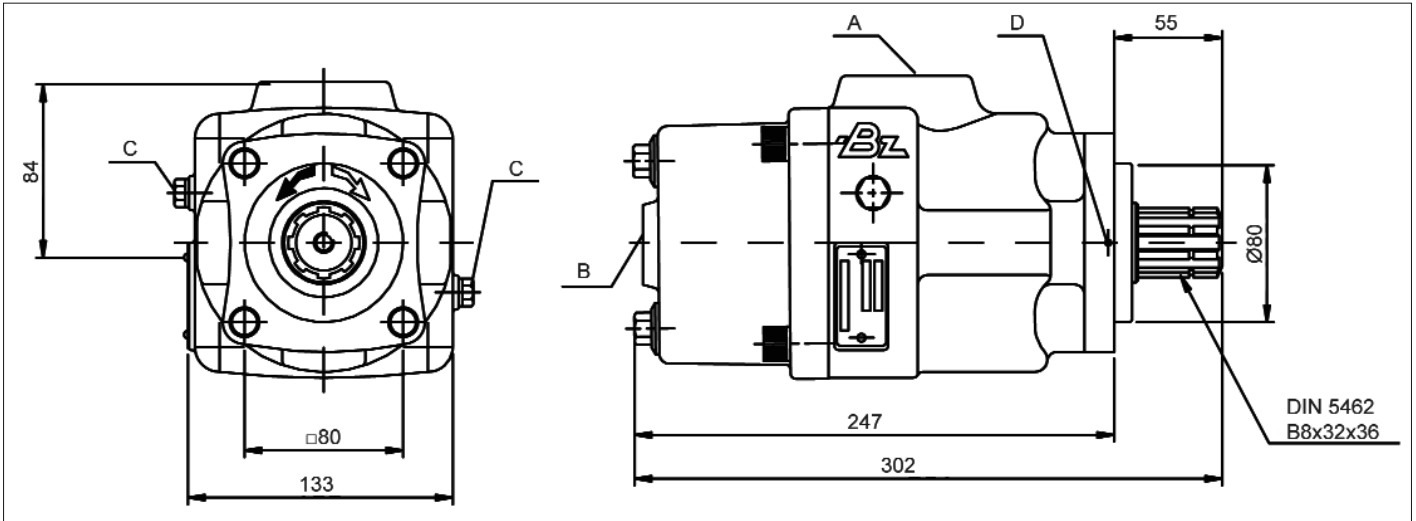

## Notas Notes

|   |   |   |                                  |
|---|---|---|----------------------------------|
| A | Entrada de Aceite, rosca BSP 1 1/2"     | A | Oil Inlet, thread BSP 1 1/2"     |
| B | Salida de aceite, rosca BSP 3/4"        | B | Oil outlet, thread BSP 3/4"      |
| C | Tapón de drenaje del aceite             | C | Oil drain plug                   |
| D | Taladro testigo de la rotura de retenes | D | Drain hole (Between shaft-Seals) |

## Curvas Características Performance Curves

